

# CRYSTAL UNIT WITH THERMISTOR

## XTL5B



### Applications

- Mobile Communication
- Automotive

### Features

- Dimensions (2.0×1.6×0.65)
- Crystal Unit with Thermistor
- Conforms to AEC-Q200
- High reliability

### Specifications



Model	XTL5B
Frequency range	26.000 ~ 52.000MHz
Nominal frequency (MHz)	26.000, 38.400, 52.000
Frequency tolerance (at +25°C)	$\pm 10 \times 10^{-6}$
Temperature tolerance (Ref. to +25°C)	$\pm 15 \times 10^{-6} \sim \pm 50 \times 10^{-6}$
Operating temperature range	-40~+125°C
Storage temperature range	-40~+125°C
Drive level	10uW (200uW max.)
Load capacitance	7pF, 8pF
Equivalent series resistance	80Ω : 26.000~38.399MHz
	50Ω : 38.400~52.000MHz
Aging	$\pm 3$ ppm / year Max.

### Thermistor

Resistance	100KΩ $\pm 1\%$
B-Constant	4250K $\pm 1\%$

Package quantity: 3,000pcs max./Reel.

### Outline and Dimensions [unit:mm]

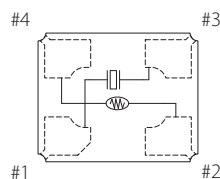
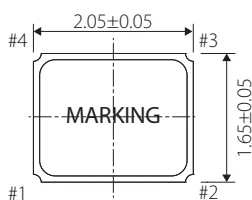

Pin Connection	
#1,#3	Crystal
#2	Thermistor & GND
#4	Thermistor

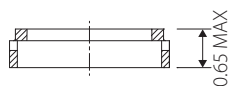

Land Pattern(REFERENCE)

